



Newsletter  
Monday 18<sup>th</sup> September 2023  
Email  
[info@gamesley.derbyshire.sch.uk](mailto:info@gamesley.derbyshire.sch.uk)  
01457 853721  
Pastoral Manager  
Tammy Snape 07922 576932



Dear Families,

We have had a great first few days in school. All the children are behaving beautifully and working so hard and our new Reception and Nursery children have settled quickly – we are very impressed by them!

## Our School Code: We are Respectful, Resilient and Ready to Learn.

Our new learning and behaviour expectations for the children in Years 1 to 6 are that everyone tries their very best to be **Respectful, Resilient and Ready to Learn**. This is what we have shared with the children to help them understand what we mean by this:

### Respectful

I am kind and have good manners  
I am polite and avoid interrupting or causing disturbances  
I listen to others and respect differences in beliefs and opinions  
I think before I speak, and consider my language and tone  
I lend a helping hand and practise compassion  
I don't talk about other people in an unkind way  
I respect personal space and property  
I understand everyone has their own experiences and beliefs  
I will speak up if others are being disrespectful  
I am willing to admit my mistakes.

### Resilient

I always try my best  
I give things a go even when they are challenging  
I can bounce back after difficult times  
I can deal with challenges and hold my head up high  
I am strong on the inside

### Ready to Learn

Food: I know that eating healthily will help me to concentrate and learn  
Sleep: I make sure I go to bed early enough so I wake up refreshed and ready to learn  
Exercise: I get lots of fresh air and exercise to keep my mind active  
Equipment: I bring everything I need for a successful day at school: water bottle, PE kit, reading book etc

And in class I make sure I am **concentrating, listening and contributing** to the learning



Newsletter  
Monday 18<sup>th</sup> September 2023  
Email  
[info@gamesley.derbyshire.sch.uk](mailto:info@gamesley.derbyshire.sch.uk)  
01457 853721  
Pastoral Manager  
Tammy Snape 07922 576932



For our Early Years children in the Nursery and Reception classes there are just two rules:

1. We are kind
2. We listen to the grown ups

## Catkins, Conker and Acorns Move Around – New rooms from Thursday 21<sup>st</sup> September

Although our new Early Years department has got off to a great start, we have realized that it could run even more efficiently if we used the rooms in a slightly different way. So on Wednesday evening we will be having another move round.

When the children come back into school on Thursday, Catkins Class will be in the current Reception Acorns Class and morning children will come into school via the left-hand side of the outside play area.

Conkers class will have moved into the current Catkins Class and Acorns will have moved over to Catkins. Both these classes will come into school via the right-hand side of the outside play area.

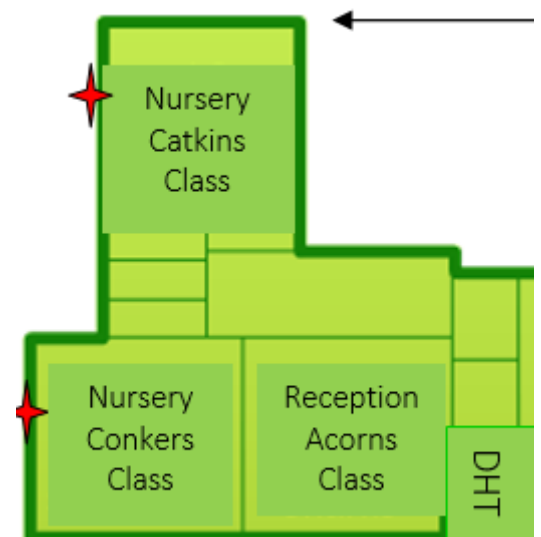

## Parking Near School

I've already sent a couple of messages via Class Dojo about this, but can I please ask families who drive to school to stop parking so close to the main gates each morning and afternoon? There are still some families parking in the little square just outside the school gates or on the road leading up to it in front of residents' houses. This is not only causing upset to our neighbours, but it is also dangerous as cars are mixing with children walking to school. There are lots of places to park just a few steps further away including the "main car park" at the front of school.

Please help to keep your children safe and to maintain our good relationship with the community by driving and parking with consideration. Thank you everyone.





Newsletter  
 Monday 18<sup>th</sup> September 2023  
 Email  
[info@gamesley.derbyshire.sch.uk](mailto:info@gamesley.derbyshire.sch.uk)  
 01457 853721  
 Pastoral Manager  
 Tammy Snape 07922 576932



## School Trips and Experiences



We remain committed to giving the children as many exciting and meaningful experiences as possible to enhance their learning in school, but as school budgets are increasingly squeezed we can only afford to do this by asking families to contribute their “share” of the cost of these activities. If we do not receive contributions from everyone for an activity, with great regret we will cancel.

Our aim this school year is that we give you as much notice as possible of all the contributions we will be asking you to make this year to help you to budget. Below is a grid of the trips and visits that have been booked so far: more details can be found on Parent Pay. We will ensure that this is completed and shared with you in the next couple of months so you are fully aware of what is coming up for the rest of the year.

|   |   |   |                                    |
|---|---|---|------------------------------------|
| <b>Conkers Nursery Class Trips and Events</b>     |   | <b>Dinosaur Experience in School</b>      | <b>Formby Beach</b>                |
| <b>Date</b>                                       |   | Wednesday 28 <sup>th</sup><br>February 24 |                                    |
| <b>Contribution per child</b>                     |   | Letter to follow                          |                                    |
| <b>Deadline for contribution</b>                  |   |   |                                    |
| <b>Reception Acorns Class Trips and Events</b>    | <b>Inside Out Forest School Day (Acorns only)</b> | <b>Dinosaur Experience in School</b>      | <b>Formby Beach</b>                |
| <b>Date</b>                                       | Wed 18 <sup>th</sup> October 2023                 | Wednesday 28 <sup>th</sup><br>February 24 |                                    |
| <b>Contribution per child</b>                     | £15.21  | Letter to follow                          |                                    |
| <b>Deadline for contribution</b>                  | Wed 27 <sup>th</sup> September 2023               |   |                                    |
| <b>Year 1 Silver Birch Class Trips and Events</b> | <b>Eureka Children’s Museum</b>                   | <b>Manchester Bus Tour</b>                | <b>Portland Basin</b>              |
| <b>Date</b>                                       | Thurs 16 <sup>th</sup> November 23                | Tuesday 19 <sup>th</sup> March 2024       | Thursday 6 <sup>th</sup> June 2024 |
| <b>Contribution per child</b>                     | £27.59  | £14.62                                    | £18.96                             |
| <b>Deadline for contribution</b>                  | Thurs 19 <sup>th</sup> October 2023               | Tues 27 <sup>th</sup> February 2024       | Tuesday 9 <sup>th</sup> May 2024   |



Newsletter  
 Monday 18<sup>th</sup> September 2023  
 Email  
[info@gamesley.derbyshire.sch.uk](mailto:info@gamesley.derbyshire.sch.uk)  
 01457 853721  
 Pastoral Manager  
 Tammy Snape 07922 576932



|   |  |   |  |
|---|--|---|--|
| <b>Year 2 Willow Class Trips and Events</b>   | <b>Manchester Art Gallery</b>  | <b>Lytham St. Anne's</b>                | <b>Skipton Castle</b>                        |
| <b>Date</b>                                   | Tuesday 14 <sup>th</sup> November  | Tuesday 9 <sup>th</sup> July 24         |  |
| <b>Contribution per child</b>                 | £12.32   | £18.33                                  |  |
| <b>Deadline for contribution</b>              | Tuesday 24 <sup>th</sup> October 23  | Tuesday 18 <sup>th</sup> June 24        |  |
| <b>Year 3 Holly Class Trips and Events</b>    | <b>Stone Age Workshop in School</b>  | <b>Chester Zoo</b>                      | <b>Manchester Walking Tour and Galleries</b> |
| <b>Date</b>                                   | Friday 13 <sup>th</sup> October 23   | Tuesday 26 <sup>th</sup> March 24       |  |
| <b>Contribution per child</b>                 | £5.17  | £19.73                                  |  |
| <b>Deadline for contribution</b>              | Friday 22 <sup>nd</sup> September 23   | Tuesday 5 <sup>th</sup> March 24        |  |
| <b>Year 4 Chestnut Class Trips and Events</b> | <b>Tatton Park</b>   | <b>Chester Zoo</b>                      | <b>Come and play with the Halle</b>          |
| <b>Date</b>                                   | Wed 11 <sup>th</sup> October 2023  | Tuesday 26 <sup>th</sup> March 24       |  |
| <b>Contribution per child</b>                 | £19.81   | £19.73                                  |  |
| <b>Deadline for contribution</b>              | Wed 20 <sup>th</sup> September 2023  | Tuesday 5 <sup>th</sup> March 24        |  |
| <b>Year 5 Elm Class Trips and Events</b>      | <b>3 Day trips to Whitehall Centre</b>   | <b>Young Voices</b>                     | <b>Alton Towers</b>                          |
| <b>Date</b>                                   | Wed 4 <sup>th</sup> October 2023<br>Thursday 5 <sup>th</sup> October 2023<br>Friday 6 <sup>th</sup> October 2023 | Wed 7 <sup>th</sup> February 2024       |  |
| <b>Contribution per child</b>                 | £25.00   | £15.57                                  |  |
| <b>Deadline for contribution</b>              | Wed 13 <sup>th</sup> September 2023  | Wed 17 <sup>th</sup> January 2024       |  |
| <b>Year 6 Oak Class Trips and Events</b>      | <b>Residential trip to Whitehall Centre</b>  | <b>Ashton Central Mosque</b>            | <b>Stockport Air Raid Shelter</b>            |
| <b>Date</b>                                   | Monday 18 <sup>th</sup> to Wednesday 20 <sup>th</sup> September 2023   | Thursday 29 <sup>th</sup> February 2024 | Tuesday 21 <sup>st</sup> May 2024            |
| <b>Contribution per child</b>                 | £25.00   | £11.71                                  | £19.68                                       |
| <b>Deadline for contribution</b>              | Mon 11 <sup>th</sup> September 2023  | Thurs 1 <sup>st</sup> February 2024     | Tuesday 30 <sup>th</sup> April 2024          |



Newsletter  
Monday 18<sup>th</sup> September 2023  
Email  
[info@gamesley.derbyshire.sch.uk](mailto:info@gamesley.derbyshire.sch.uk)  
01457 853721  
Pastoral Manager  
Tammy Snape 07922 576932



## Stars of the Week

Congratulations to our first stars of the new school year.

Last week we were all learning about the importance of being “kind” and the children chosen to be celebrated for embodying this value so well were:

|                     |   |
|---------------------|---|
| Nursery Conkers     | Luca has been so kind helping his friends to hang up their coats and bags each morning.         |
| Reception Acorns    | Annabelle has been so helpful and kind towards all her friends in Acorns Class.                 |
| Year 1 Silver Birch | Amira has been saying kind things to everyone in Silver Birch Class and has been so helpful.    |
| Year 2 Willow       | Hugo is always kind to adults and children.   |
| Year 3 Holly        | Emma has been so kind and patient to her classmates this week.                                  |
| Year 4 Chestnut     | Jamie was a very kind friend in our PE lesson this week, supporting his peers to do their best. |
| Year 5 Elm          | Annabella is kind and considerate and always has a big smile for everyone.                      |
| Year 6 Oak          | Arthur is such a kind and sharing learning partner.   |
| Orchard Group       | Jaxon has been sharing with everyone in Orchard Group.  |

We also chose our first reading stars of the new year who were:

|                     |   |
|---------------------|---|
| Nursery Conkers     | Frankie loves books – he says his favourite is “The Gruffalo”!  |
| Reception Acorns    | Reggie has been sharing stories with grown-ups in school and has read with his family at home 6 times this week   |
| Year 1 Silver Birch | Leo has been working very hard in our daily reading lessons and has also been practising every night at home.   |
| Year 2 Willow       | Jenson has read at home every single day this year. What a great start!   |
| Year 3 Holly        | Thomas is such an enthusiastic reader and loves books!  |
| Year 4 Chestnut     | Harriet has been practising her reading at home every night and been enthusiastic and proactive in our daily reading lessons.   |
| Year 5 Elm          | Eva reads regularly at home and demonstrates enthusiasm and motivation in school.   |
| Year 6 Oak          | Jacob absolutely loves to read. He was so enthused by this week’s guided reading extract from “The Peppermint Pig” that he has requested that the book be bought for the class. |

Kindest regards,

*Deborah Meredith*



Newsletter  
 Monday 18<sup>th</sup> September 2023  
 Email  
[info@gamesley.derbyshire.sch.uk](mailto:info@gamesley.derbyshire.sch.uk)  
 01457 853721  
 Pastoral Manager  
 Tammy Snape 07922 576932



| <b>Dates for your Diary</b>                       |  |
|---|--|
| Monday 18 <sup>th</sup> September                 | Year 6 Oak Class subsidised residential trip to Whitehall Centre                           |
| Wed 4 <sup>th</sup> to Fri 6 <sup>th</sup> Oct 23 | Year 5 Elm Class subsidised 3-day course at Whitehall Centre (not residential)             |
| Wednesday 11 <sup>th</sup> October 23             | Year 4 Chestnut Class visit to Tatton Park   |
| Friday 13 <sup>th</sup> October 23                | Year 3 Holly Class "Stone Age Dig" workshop in school                                      |
| Thursday 19 <sup>th</sup> October 23              | Individual photographs for all Nursery and School children.                                |
| Friday 20 <sup>th</sup> October 23                | Year 6 Family Dinner Day: 12.30pm  |
| Friday 27 <sup>th</sup> October 2023              | Year 5 Family Dinner Day: 12.30pm  |
| <b>Friday 27<sup>th</sup> October 23</b>          | <b>Schools close for Autumn Half term Holiday</b>  |
| <b>Monday 6<sup>th</sup> November 23</b>          | <b>Schools open for Autumn Term 2</b>  |
| Friday 10 <sup>th</sup> November 23               | Year 4 Family Dinner Day: 12.30pm  |
| Tuesday 14 <sup>th</sup> November 23              | Year 2 Willow Class trip to Manchester Art Gallery   |
| Thursday 16 <sup>th</sup> November 23             | Year 1 Silver Birch Class trip to "Eureka" Museum  |
| Friday 17 <sup>th</sup> November 23               | Year 3 Family Dinner Day: 12.20pm  |
| Friday 24 <sup>th</sup> November 23               | Year 2 Family Dinner Day: 12.15pm  |
| Friday 1 <sup>st</sup> December 23                | Year 1 Family Dinner Day: 12.10pm  |
| Friday 8 <sup>th</sup> December                   | Reception Family Dinner Day: 12.00 noon  |
| <b>Thursday 21<sup>st</sup> December 23</b>       | <b>Schools close for Christmas Holiday</b>   |
| <b>Monday 8<sup>th</sup> January 24</b>           | <b>Schools open for Spring Term 1</b>  |
| <b>Friday 16<sup>th</sup> February 24</b>         | <b>Schools close for Half Term Holiday</b>   |
| <b>Monday 26<sup>th</sup> February 24</b>         | <b>Schools open for Spring Term 2</b>  |
| Wednesday 7 <sup>th</sup> February 24             | Year 5 Elm Class take part in "Young Voices" concert                                       |
| Wednesday 28 <sup>th</sup> Feb 24                 | Nursery Conkers and reception Acorns classes take part in Baby Dinosaur workshop in school |
| Thursday 29 <sup>th</sup> February 24             | Year 6 Oak Class trip to Ashton Central Mosque   |
| Tuesday 19 <sup>th</sup> March 24                 | Year 1 Silver Birch Manchester Bus Tour  |
| Tuesday 26 <sup>th</sup> March 24                 | Year 3 Holly and Year 4 Chestnut classes trip to Chester Zoo                               |
| <b>Thursday 28<sup>th</sup> March 24</b>          | <b>Schools close for Easter Holiday</b>  |
| <b>Monday 15<sup>th</sup> April 24</b>            | <b>Schools open for Summer Term 1</b>  |
| Tuesday 21 <sup>st</sup> May 24                   | Year 6 Oak class visit to Stockport Air Raid Shelter                                       |
| <b>Thursday 23<sup>rd</sup> May 24</b>            | <b>Schools close for Half Term Holiday</b>   |
| <b>Monday 3<sup>rd</sup> June 24</b>              | <b>Schools open for Summer Term 2</b>  |
| Thursday 6 <sup>th</sup> June 24                  | Year 1 Silver Birch visit to Portland Basin  |
| Tuesday 9 <sup>th</sup> July 24                   | Y2 Willow Class visit to Lytham St. Anne's   |
| <b>Tuesday 23<sup>rd</sup> July</b>               | <b>Schools close for Summer Holiday</b>  |